

Parcel 12

Boston Civic Design Commission

AUGUST 6, 2019

**Samuels &
Associates**

ELKUS | MANFREDI
ARCHITECTS

WHAT WE HEARD

Office Building

- Office building looks wide, especially from the western approach
- Boylston Street facade seems very regular and unrelieved

Hotel/Residential Building

- Hotel/Residential building is very promising and elegant

Western Facade

- Study the view from the eastbound lane, as that is the proper approach view
- The structural supports distract from the building architecture; there are too many architectural moves going on; simplify
- The wave of the upper plaza seems too exposed to the west

Plaza & Retail

- Weave together the podium architecture with the two towers
- The public plaza is an incredible offering to the public

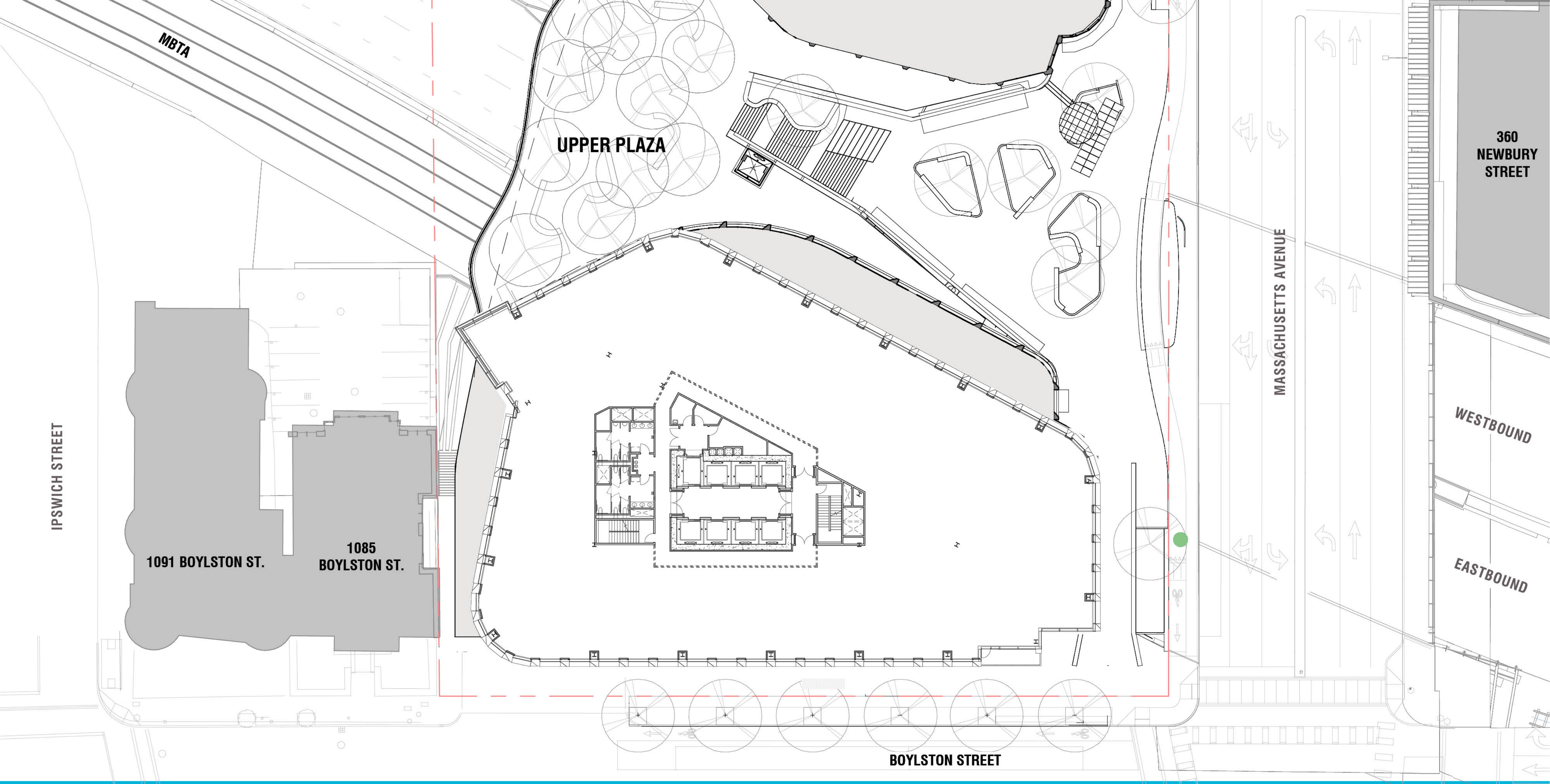

MBTA

UPPER PLAZA

360
NEWBURY
STREET

MASSACHUSETTS AVENUE

WESTBOUND

EASTBOUND

IPSWICH STREET

1091 BOYLSTON ST.

1085
BOYLSTON ST.

BOYLSTON STREET



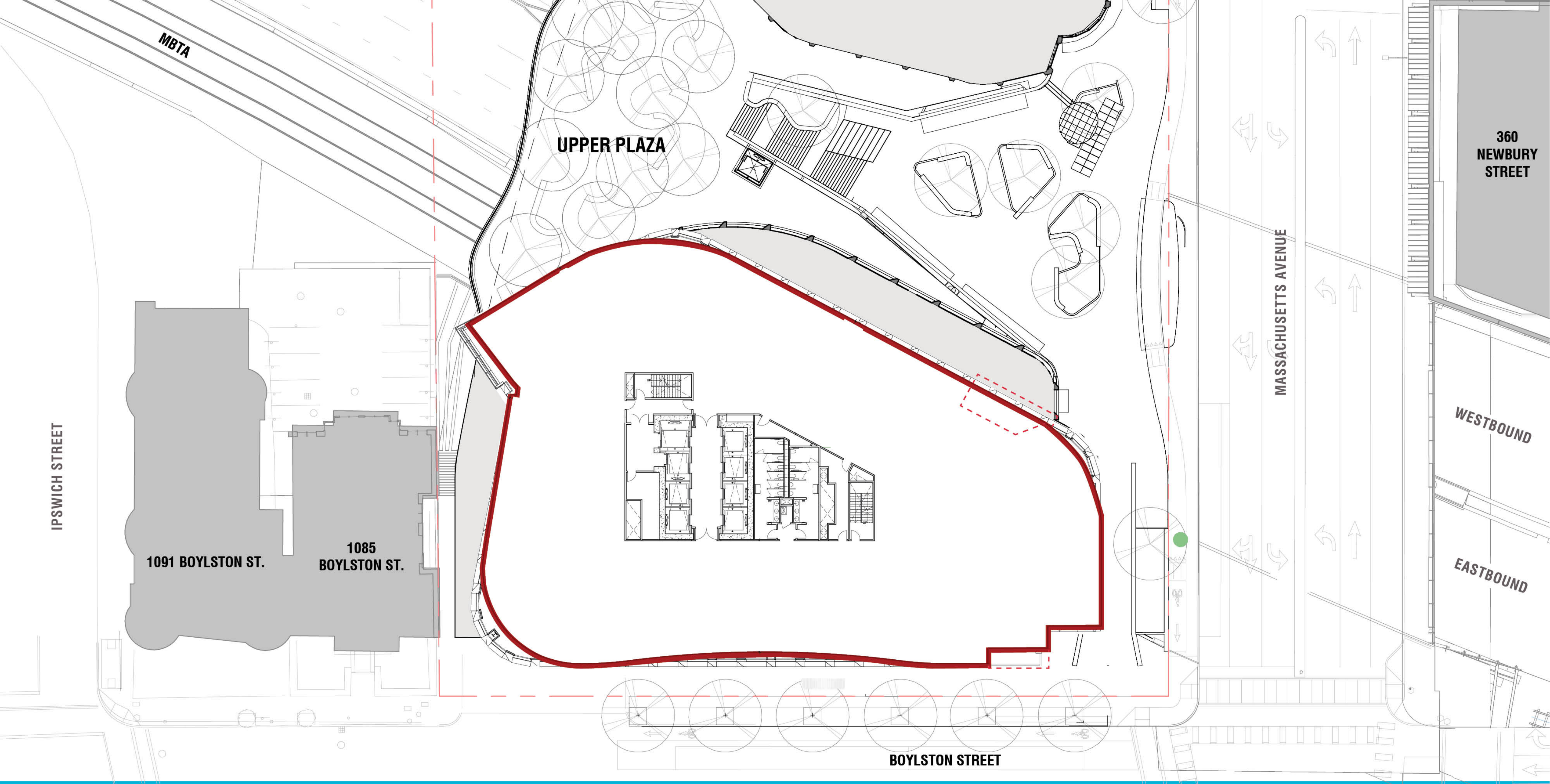





© ELKUS MANFREDI ARCHITECTS

PARCEL 12 AIR RIGHTS PROJECT
BOSTON, MASSACHUSETTS

VIEW FROM BOYLSTON STREET

Samuels & Associates

ELKUS | MANFREDI
ARCHITECTS





© ELKUS MANFREDI ARCHITECTS







RECONFIGURED ON-RAMP
MASSACHUSETTS TURNPIKE
WESTBOUND
MASSACHUSETTS TURNPIKE
EASTBOUND

HOTEL/
RESI

LEVEL 3 TERRACE

LEVEL 3 TERRACE

PARCEL 13
(PROPOSED)

OFFICE

IPSWICH STREET

MASSACHUSETTS AVENUE

NEWBURY STREET

BOYLSTON STREET







Parcel 12

Boston Civic Design Commission

AUGUST 6, 2019

**Samuels &
Associates**

ELKUS | MANFREDI
ARCHITECTS